

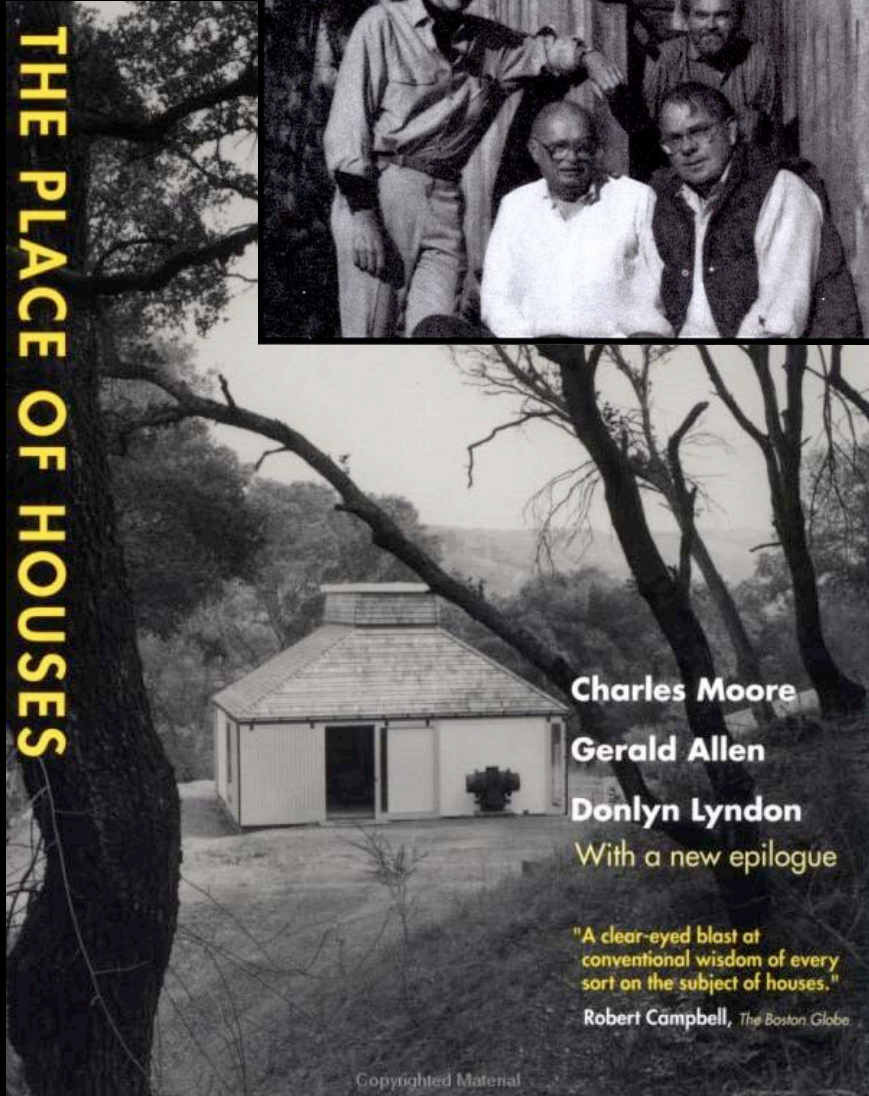

Charles W. Moore

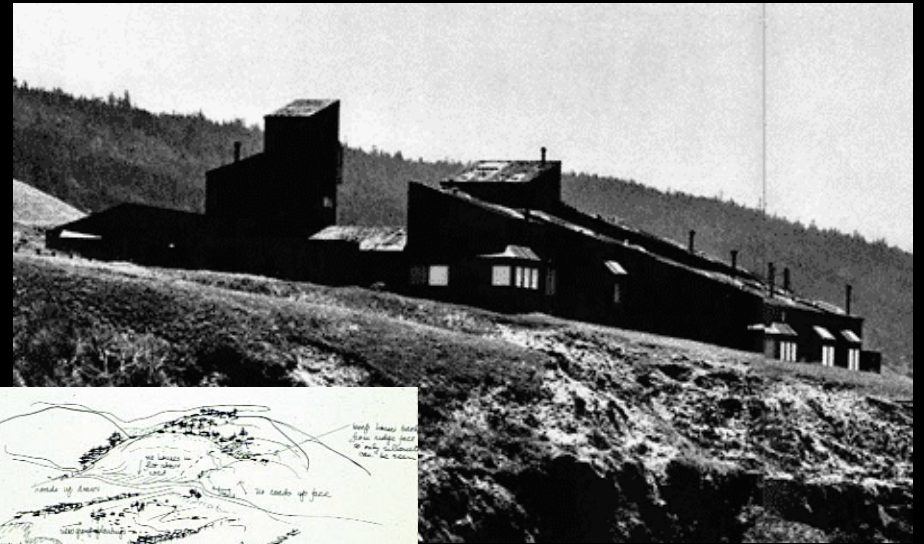

THE PLACE OF HOUSES



Charles Moore
Gerald Allen
Donlyn Lyndon
With a new epilogue

"A clear-eyed blast at conventional wisdom of every sort on the subject of houses."

Robert Campbell, *The Boston Globe*

Copyrighted Material





Source: Manuscripts & Archives, Yale University Library
Produced for reference use only (mssa.img.8853)

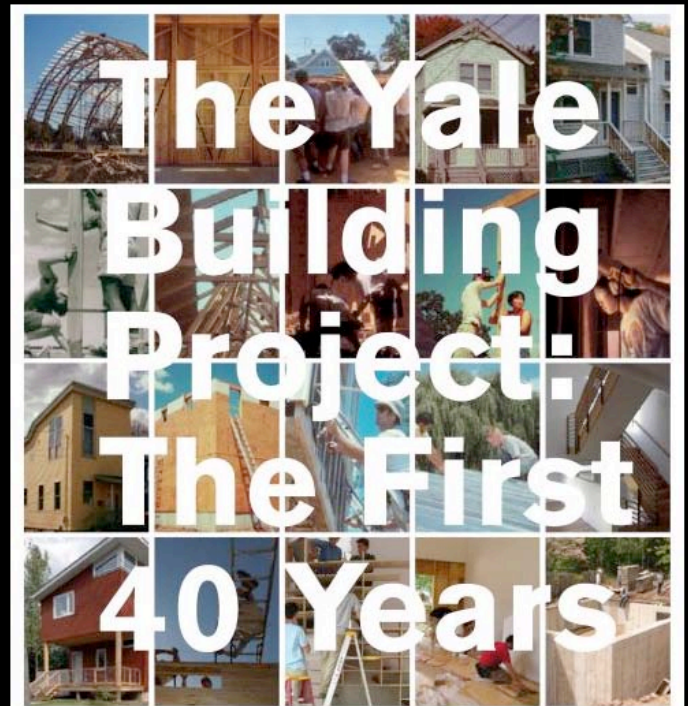

Richard W. Hayes
Yale School of Architecture

Body, Memory, and Architecture

Kent C. Bloomer and Charles W. Moore
with a contribution by Robert J. Yudell

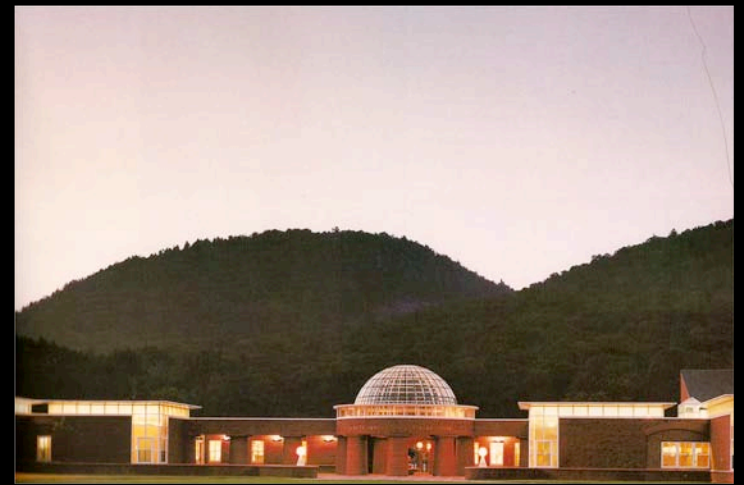
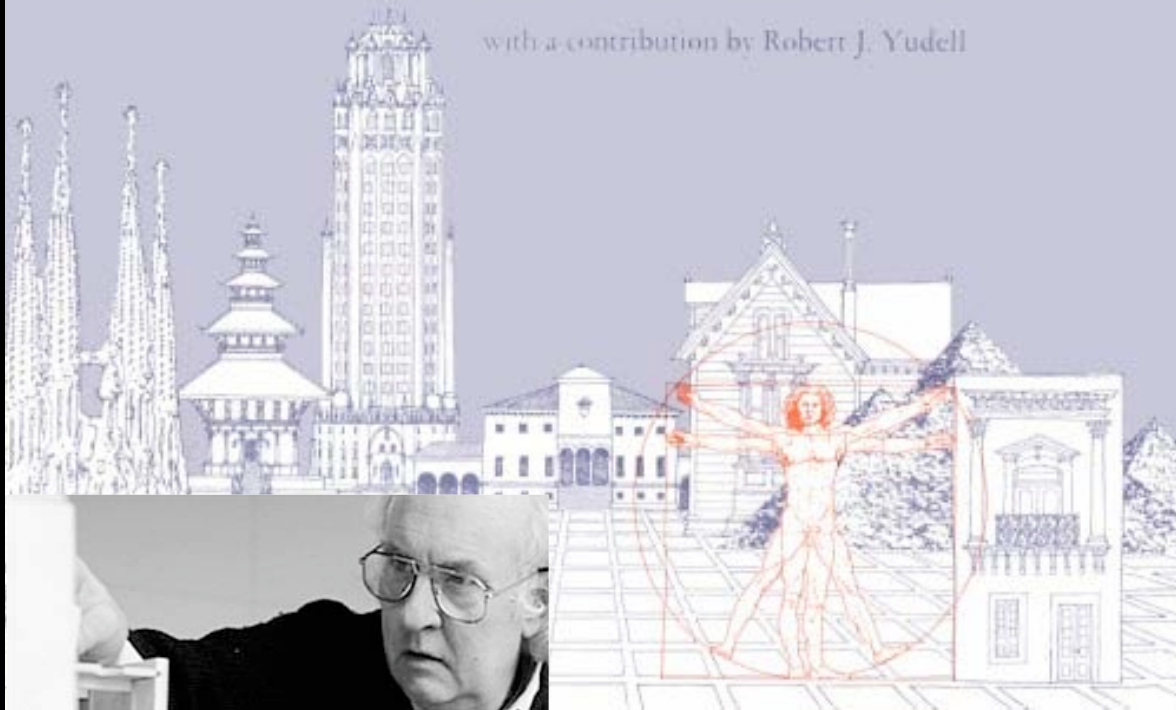

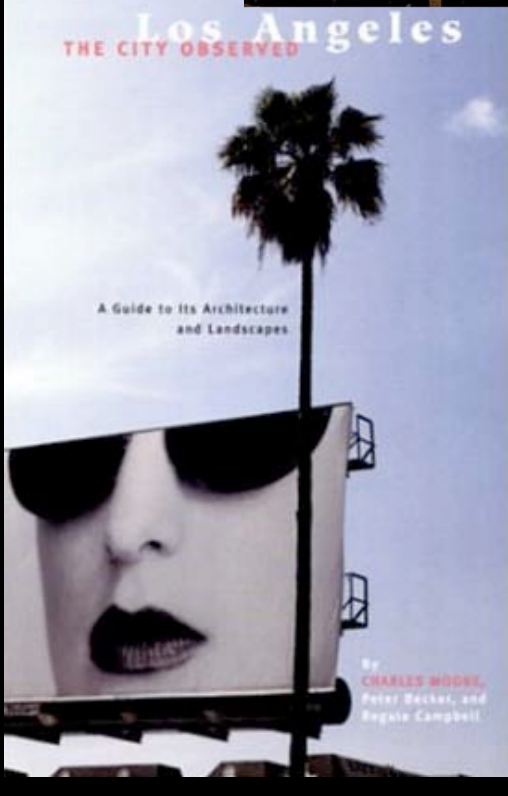

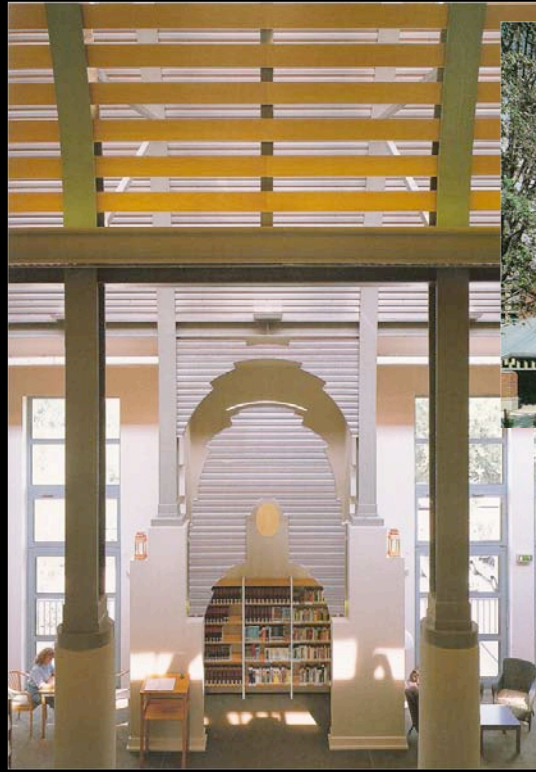

CHAMBERS FOR A MEMORY PA



DONLYN LYNDON AND CHARLES W. MOORE

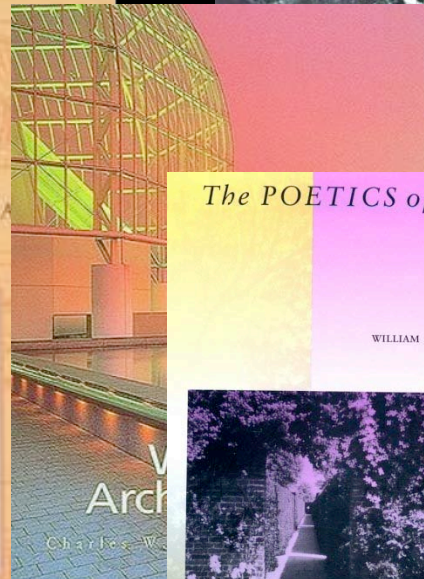

The POETICS of GARDENS

CHARLES W. MOORE
WILLIAM J. MITCHELL
WILLIAM TURNBULL, JR.

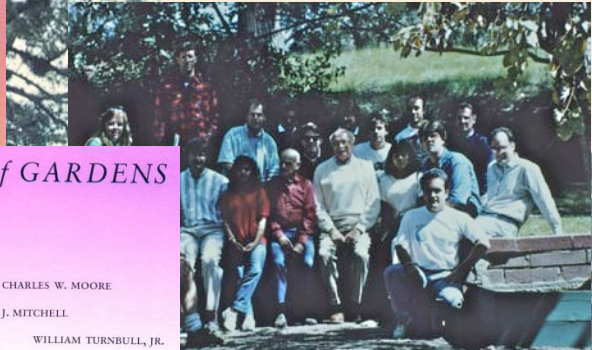
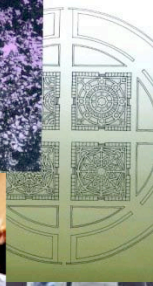

Moore Andersson Compound

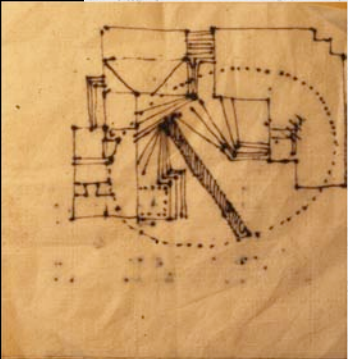



The PLACE OF HOUSES
Water Architecture

The PLACE OF HOUSES

The POETICS OF GARDENS

Body, Memory, and Architecture

The Yale Building Project: The First 40 Years

Los Angeles